

POWER LINE - for dry shelves & refrigerated cabinets

POWER LINE

The Lumitech Power Line provides quick and convenient wiring of linear LED luminaires and drivers.



PRODUCT DESCRIPTION

- Designed for all types of dry shelves, as well as refrigerated cabinets (e.g. wall-mounted refrigerated shelves) in supermarkets
- Suitable for retrofit and first fit
- Specially designed for the dimensions of all commercially available furniture geometries
- Newly developed overall concept to meet all necessary norms & standards of the industry
- Cost savings thanks to easy integration into the furniture with reduced installation times
- Retrofits can be made on the fly (no need to clear out goods, as no drilling or similar is required)
- Lumitech Branding

BENEFITS

- Quick & easy installation of the entire system
- Maximum flexibility when connecting the lights (plug & play)
- Mounting of the power rail by magnetic tape or adhesive tape
- Optimized, tool-free connection to the furniture (chip-free)

TECHNICAL DATA

Supply voltage	24 VDC
Ambient temperature ta	-30 ... +30 °C
Colours	white matt (RAL 9003) blackgrey matt (RAL 7021)
Max. electrical load capacity	108W / 4,5A
Max. mechanical load capacity	15 Newton
Dimensions (WxH)	20mm x 7,6mm
Standards	according to EN 60335-2-89, EN 60570

The user is responsible for ensuring the max. electrical, mechanical & thermal properties.

POWER LINE

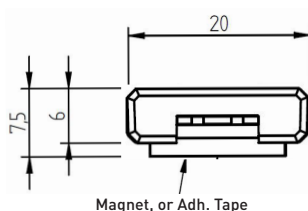

- Plug-in system for connecting several LED luminaires
- End caps are included (already mounted on the power rails)

ORDER DATA

Art. No.	Type	Length	Fixation
89601627	POWER LINE magnetic, bk, 1250mm incl. Endcaps	1250mm	Magnet
89601628	POWER LINE magnetic, wht, 1250mm incl. Endcaps	1250mm	Magnet
89601656	POWER LINE magnetic, wht, 1500mm incl. endcaps	1500mm	Magnet
89601657	POWER LINE magnetic, wht, 1800mm incl. endcaps	1800mm	Magnet
89601651	POWER LINE foam tape, bk, 900mm incl. endcaps	900mm	Adh. Tape
89601643	POWER LINE foam tape, bk, 1250mm incl. endcaps	1250mm	Adh. Tape
89601644	POWER LINE foam tape, bk, 2000mm incl. endcaps	2000mm	Adh. Tape

POWER LINE

FEEDER

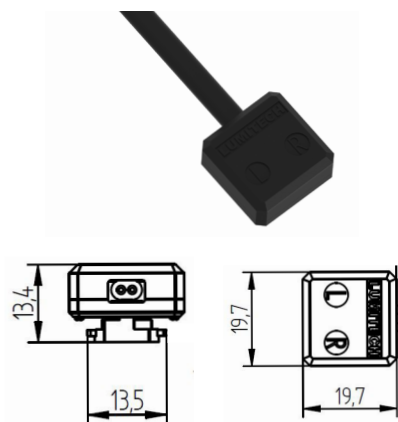

- Connection cable incl. plug
- Can be used for luminaires as well as for connecting the driver

ORDER DATA

Art. No.	Type	Cable length	Colour
89601649	FEEDER for Power Line, bk, 700	700mm	black
89601650	FEEDER for Power Line, wht, 700	700mm	white
89601654	FEEDER for Power Line, bk, 3000	3000mm	black
89601655	FEEDER for Power Line, wht, 3000	3000mm	white

Reverse polarity protection

The plug can only be attached to the busbar in one direction (asymmetrical design)

ADAPTER CABLE - CINCH TO POWER LINE

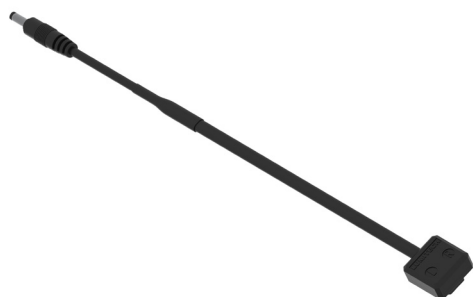

- Adapter to be able to connect Cinch luminaires to the power rail
- Two types of Cinch connectors possible (straight & angled)
- Cinch dimensions, as well as further accessories (e.g. bridges) can be found in the respective [datasheet](#).

ORDER DATA

Art. No.	Type	Cable length	Design of Cinch plug
89601324	LED Feeder straight CINCH & PL bk 600	600mm	straight
89601342	LED Feeder straight CINCH & PL bk 900	900mm	straight
89601347	LED Feeder straight CINCH & PL bk 1500	1500mm	straight
89601348	LED Feeder straight CINCH & PL bk 3000	3000mm	straight
89601340	LED Feeder angled CINCH & PL bk 700	700mm	angled

Reverse polarity protection

The plug can only be attached to the busbar in one direction (asymmetrical design)

MOUNTING - FEEDER TO POWER LINE

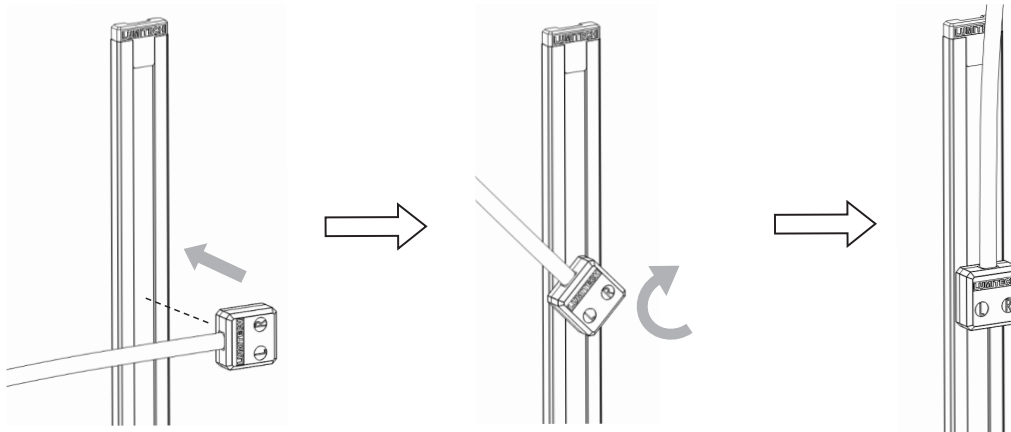

Attention:

- do not bridge conductors
- only compatible with protection class III
- SELF driver required

POWER LINE

CONNECTOR FIXING CLIP



- Pull-off protection for the busbar connector
- Cable run inside the loop

ORDER DATA

Art. No.	Type	Colour
89601636	CONNECTOR FIXING CLIP Power Line bk	black
89601637	CONNECTOR FIXING CLIP Power Line wht	white

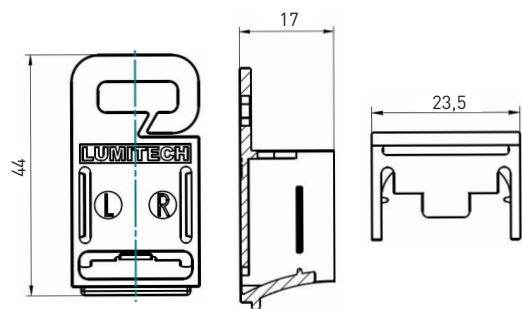

Latch protection

The Connector Fixing clip can only be installed when the feeder is mounted correctly

Pull-off protection

The Connector Fixing clip must first be removed before the feeder can be detached

Disassembly of the Connector Fixing clip

Pull upwards on the loop

MOUNTING THE CONNECTOR FIXING CLIP

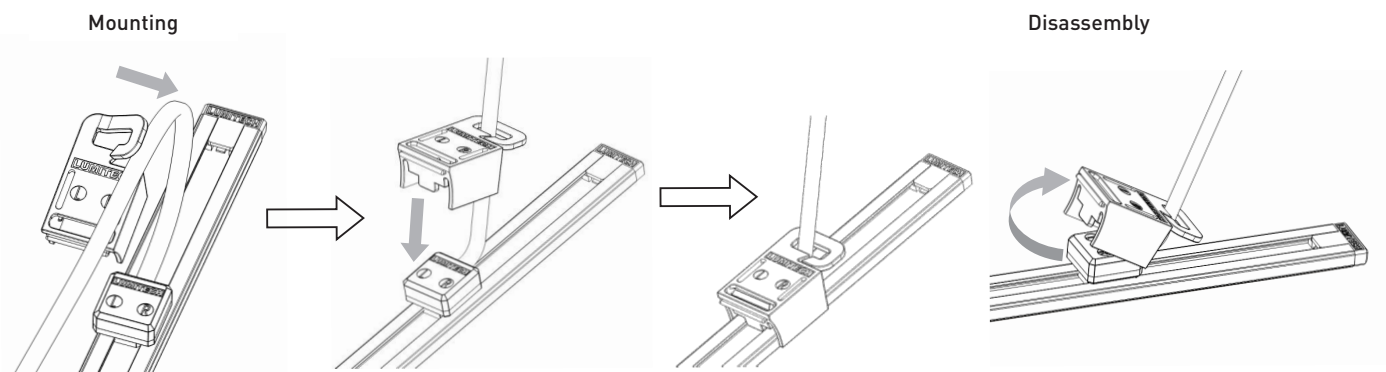

PROTECTION STRIP

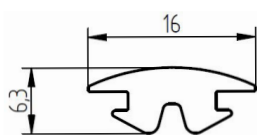
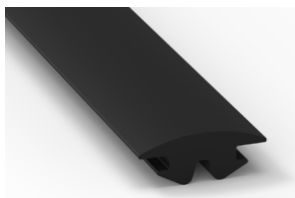

- Silicone protection strip (sold by the meter)
- Protection against short circuit & oxidation
- Mount the protection by pressing it into the power line

ORDER DATA

Art. No.	Type	Colour
89601638	PROTECTION STRIP flexible, bk, xxx	black
89601639	PROTECTION STRIP flexible, wht, xxx	white